

LAND & LAKES @ Mount Pleasant Business Park



Site Overview



Municipality: Village of Mount Pleasant

Zoning: Business Park

Available Acres: 60 Acres for Build to Suit

Lease Rate: \$5.25 Per Square Foot

Note: Land purchase subject to offer

Located in a Tax Increment District

 - Business Park Location

Distance to Closest



1 mile to I-94
Direct access to State Trunk Highway 20



8 miles to Racine's Batten International
19 miles to Milwaukee's Mitchell International
57 miles to Chicago's O'Hare International



Area serviced by Canadian Pacific & Union Pacific rail lines.



24 miles to Milwaukee Port
83 miles to Illinois International Port

Available Incentives



- State Job Creation & Retention Tax Credits
- Fixed Low-Interest Loans
- Workforce Assistance & Grants
- State Manufacturing Tax Credit (direct)
- State Manufacturing Tax Exemptions

Community Profile



**Racine County*

Population: 195,408

Labor Force: 127,796

Unemployment Rate: 6.40%

Mill Rate: \$21.15 per \$1,000



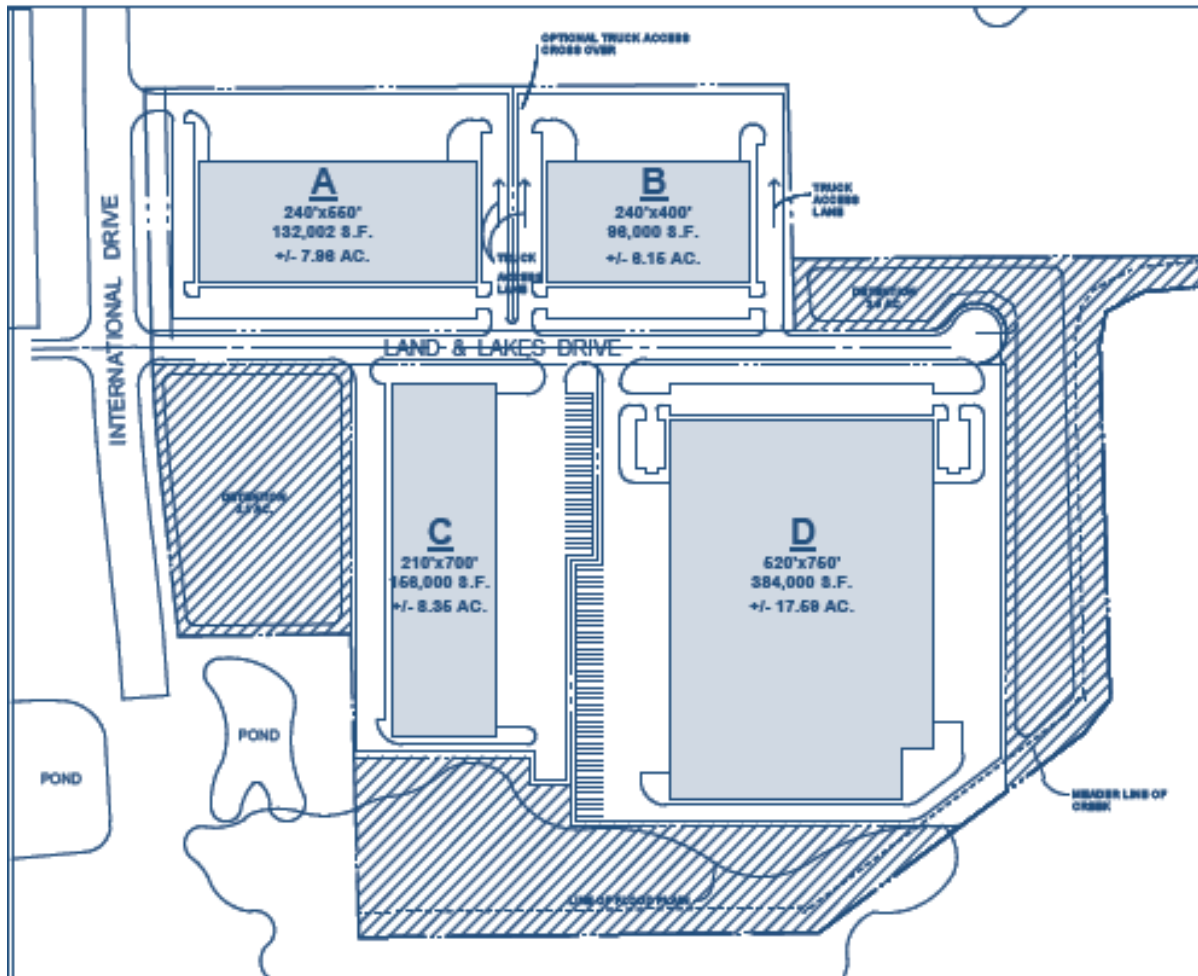

Contact: Mike Prost
 NGKF
 773-957-1430
 mprost@ngkf.com

Sergio Chapa
 NGKF
 773-957-1430
 schapa@ngkf.com

Available Services



Sanitary Sewer:

Mount Pleasant Sewer Utility 262-664-7850

Public Water:

City of Racine Water Utility 262-636-9181

Electric Power & Natural Gas:

WE Energies 800-242-9137

Telecommunications:

Service available through various providers.

Prominent Employers in the Area



- All States Trucking
- Cordstrap
- North American Distribution Co.
- Poclairn Hydraulics
- Racine Metal-Fab
- SEDA Packaging International



For More Information Contact:
 Jordan Brown, Business Recruitment Specialist
 Jbrown@racinecountyedc.org | 262.898.7444